

ifi UP TRAVEL

Quick Start Guide

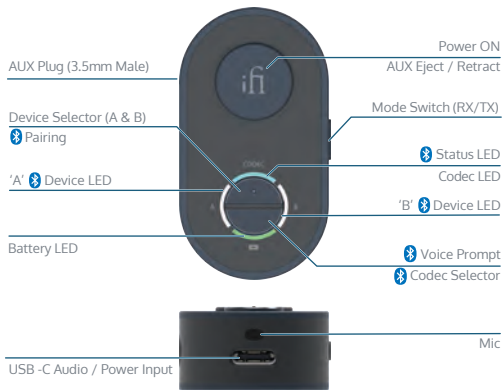

1 Power

Power ON

- Light press: AUX 90°
- Heavy press: AUX 180°



2 TX Mode



Battery Status LED

50% - 100%

21% - 49%

≤ 20%

Charging

Fully Charged

3 RX Mode

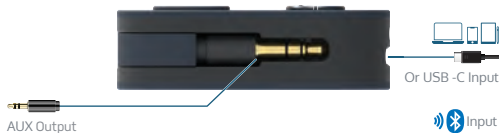

4 'A' / 'B' Device Selector / Pairing



Short press: Cycle Selector

A + B > A > B



Long press:  Pairing  



Connect via phone:
Turn on 
select UP Travel.

5 TX/RX Mode Selector



6 Codec Format Selector and LED / Voice Prompt



Short press:
Codec cycle

USB DAC

44.1-48kHz

88.2-96kHz

LED



SBC



AAC (RX only)



aptX



aptX HD



aptX Adaptive



aptX Low Latency (TX only)



LDAC



LHDC/HWA (RX only)



Long press:
Codec and sample rate



mobile app



Scan QR code for Set-Up Video

Ver1.0